

## Loweswater Avenue, Bradford, BD6

**£120,000**

None

**Tenure:** Freehold, **Bedrooms:** 3

Housesimple are pleased to offer for sale this three bedroom semi-detached property which briefly comprises entrance porch, breakfast kitchen, and lounge. To the first floor, the landing gives access to three bedrooms and bathroom/WC. Externally there are gardens to the front and rear, driveway and

### Key features:

- Well Presented
- Ideal for the growing family or first time buyers
- Garage
- Two double bedrooms
- Viewings Highly Recommended
- Close to local amenities

## Extra info:

- **Property Age:** 39 years
- **Council Tax:** Band B (£115.00 per-month)
- **Double Glazing:** All
- **Heating:** Gas
- **Parking:** Single Garage and Driveway



Housesimple are pleased to offer for sale this three bedroom semi-detached property which briefly comprises entrance porch, breakfast kitchen, and lounge. To the first floor, the landing gives access to three bedrooms and bathroom/WC. Externally there are gardens to the front and rear, driveway and garage. The property benefits from double glazing as stated and gas central heating system and no onward chain. Viewing is highly recommended to appreciate the accommodation on offer which provides access to local amenities.

## ACCOMMODATION

**LOUNGE:** 16'5" (4.98m) x 12'4" (3.56m) (max). Feature fire surround, marble effect inset, and hearth, living flame gas fire, UPVC glazed door to garden.

**KITCHEN/Dining :** 15'10" x 8'1" (2.59m) (plus stairs). Fitted kitchen incorporating a range of wall and base units with worktops, 1 1/2 bowl stainless steel sink unit, built-in oven hob and extractor, splashback tiled walls, UPVC door.

**FIRST FLOOR LANDING:** Loft access.

**BEDROOM 1:** 8'3" (2.95m) (max plus robes) x 10'2" (2.34m). Built in wardrobes.

**BEDROOM 2:** 8'3" (2.97m) x 8'04" (1.78m).

**BEDROOM 3:** 7'4" (2.97m) x 7'6" (1.70m) (max).

**BATHROOM:** Three piece suite, fitted over bath shower.

**OUTSIDE:** Garden and patio to rear, off-road parking, garden to the front and garage.

Floor plan:

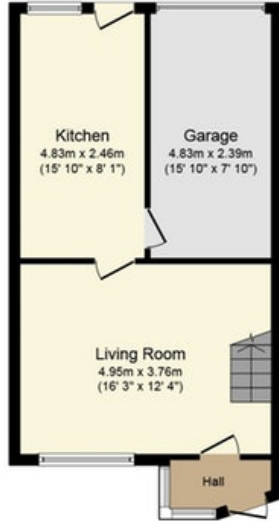

Ground Floor

Floor area 45.0 sq. m. (484 sq. ft.)  
approx

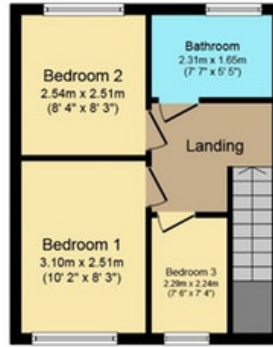

First Floor

Floor area 31.0 sq. m. (334 sq. ft.)  
approx

Total floor area 76.0 sq. m. (818 sq. ft.) approx

This Floor Plan is for illustration purposes only and may not be representative of the property. The position and size of doors, windows and other features are approximate. Unauthorized reproduction prohibited. © PropertyBOX

## Energy Performance Certificate:

# Awaiting EPC

### MISREPRESENTATION ACT, 1967.

Conditions under which these particulars are issued Housesimple.com for themselves and for the vendors or lessors of this property whose agents they are, give notice:- These particulars do not constitute, nor constitute any part of, an offer or contract. All statements contained in these particulars as to this property are made without responsibility on the part of Housesimple.com or the vendors or lessors. None of the statements contained in these particulars as to this property are to be relied on as statements or representations of fact. Any intending purchasers or lessees must satisfy themselves by inspection or otherwise as to the correctness of each of the statements contained in these particulars. The vendors or lessors do not make or give, and neither Housesimple.com nor any person in their employment has any authority to make or give, any representations, or warranty whatever in relationship to this property.

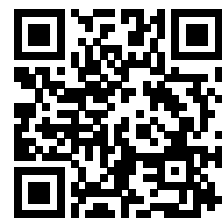

To book a viewing scan this code